

V-BELTS NOTCHED TPU  
TYPE SMOOTH  
REINFORCED POLYESTER

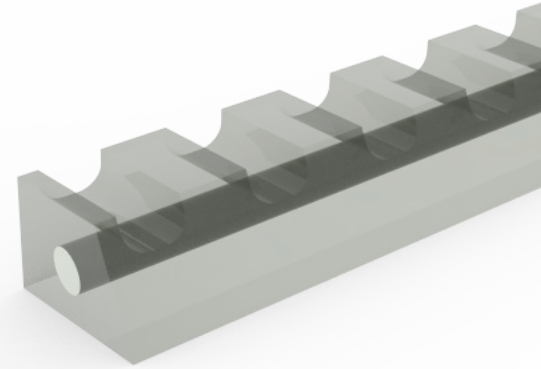
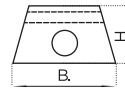

EXTRUDINGSKILL offers a wide range of V-Belts of thermoplastic polyurethane (TPU) on the market. The high strength and precision of the dimensions make them indispensable for applications that demand reliability. Available in simple profiles, reinforced polyester and reinforced kevlar in different colours and hardness. Our trapezoidal belts are available also for stop lines/boot and for packaging machinery.

Other profiles V Special-Belt are suitable for lines for ceramic glazing/tiles. Many of our belts have a USDA certificate / FDA / 3a Dairy and EC for food contact. EXTRUDINGSKILL offers special instrument to weld their belts.

Material: **PU**  
Hardness: **SH 85 A**  
Colour: **TRANSPARENT**  
Tolerance: **+/- 3 SHA**

CODE	PROFILE DIMENSION (BXH)	CROSS SECTION	APPROX WEIGHT	STANDARD ROLL		RACCOMENDED MIN. PULLEY Ø		F MAX / BELT STANDARD	
		CM <sup>2</sup>	KG/100M	M	FT	MM	INCH	MM	INCH
<b>211911506374</b>	<b>13X8 (A)</b>	<b>0,820</b>	<b>10,0</b>	<b>30</b>	<b>98,4</b>	<b>70</b>	<b>2,8</b>	<b>22,0</b>	<b>48,3</b>
<b>211911506974</b>	<b>17X11 (B)</b>	<b>1.460</b>	<b>18,0</b>	<b>30</b>	<b>98,4</b>	<b>90</b>	<b>3,6</b>	<b>39,9</b>	<b>87,7</b>
<b>211911508574</b>	<b>22X14 (C)</b>	<b>2.400</b>	<b>29,0</b>	<b>30</b>	<b>98,4</b>	<b>120</b>	<b>4,8</b>	<b>65,5</b>	<b>144,0</b>